



# ***AV 4020***

## ***User Manual***

pure acoustics®

AV-4020



**155W CH**  
Power Output

**4K**  
Resolution



Bluetooth



Phono Input



2 MIC Input



Dual Zone



SUB Out



HDMI  
Input/Output



Optical Input



FM Radio



IR Remote

**TABLE OF CONTENTS**

Warning .....	1~2
Features .....	3
Specifications .....	3
Front Panel .....	4
Remote .....	4
Rear Panel .....	5
Setup & Operation .....	5~6
Connections .....	6~9
Warranty Information .....	10

## **WARNING**

### **CAUTION**

To reduce the risk of electric shock, do not remove the cover.  
No user-serviceable parts inside. Refer servicing to qualified personnel.



English

### **WARNING**

To prevent fire or electric shock, do not expose this equipment to rain or moisture.  
Do not use this unit near water.



The lightning flash with arrowhead symbol within an equilateral triangle is intended to alert the user to the presence of uninsulated “dangerous” voltage within the product’s enclosure that may be of sufficient magnitude to constitute a risk of electric shock to humans.



The exclamation point within an equilateral triangle is intended to alert the user to the presence of important operating and maintenance (servicing) instructions in this manual.



The lightning flashes printed next to the output terminals of the amplifier are intended to alert the user to the risk of hazardous energy. Output connectors that could pose a risk are marked with the lightning flash. Do not touch output terminals while amplifier power is on. Make all connections with amplifier turned off.

- \* Maximum operating outdoor temperature is 50°C (122°F).
- \* Never restrict airflow through the device fan or vents. Please insure that the air intake and exhaust vents are unobstructed.
- \* Do not install near any heat sources such as radiators, heat registers, stoves, or other unit (including amplifiers) that produce heat.
- \* Do not defeat the safety purpose of the grounding-type plug. The grounding plug has two blades and a grounding prong. The third prong is provided for your safety. If the provided plug does not fit your outlet, consult an electrician for the replacement of the obsolete outlet. Do not cut off the grounding prong or use an adapter that breaks the grounding circuit. This apparatus must be properly grounded for your safety.
- \* Protect the power cord from being walked on or pinched, particularly plugs, convenience receptacles, and the point where they exit from the apparatus.
- \* The appliance shall not be exposed to dripping or splashing and no objects filled with liquids, such as vases, shall be placed on the apparatus.

## Clearance Space

This device gives off heat, and a 5 cm (2 inch) space on all sides will enable necessary air circulation above and below.

To keep this device within normal functioning temperature conditions, do not leave it near a source of heat or exposed to direct sunlight. Operate only on a firm surface (do not operate on a bed, cushion, sofa or any other surface of this type) because this may obstruct ventilation openings underneath.

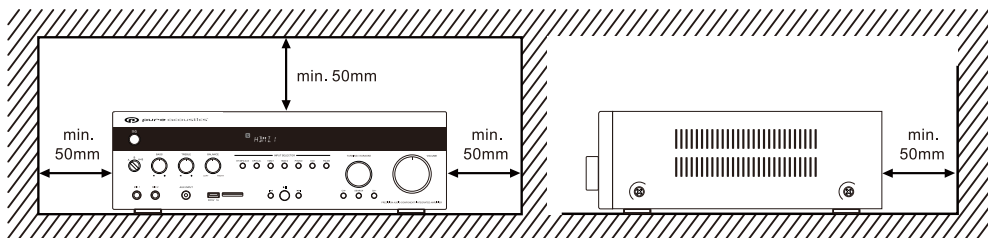

## FEATURES

- Aluminum front Panel, Audio / Video Amplifier
- With AM/FM radio, auto search and preset 100 channels
- With Wireless Music Stream Function
- HDMI 2 input 1 output
- With USB/MMC, Digital VFD Display
- With memory function

## SPECIFICATIONS

- Output power: 200 Watts RMS x 2 @ 4 Ohms  
150 Watts RMS x 2 @ 8 Ohms
- Wireless music stream audio input
- 2 inputs / 1 output HDMI
- Wireless microphone inputs
- USB/MMC input (Audio / Video play)
- MP3 analog input (3.5 mm mini-jack)
- FM/AM tuner
- Support Record, Pre-amplifier, Subwoofer output (RCA)
- Supply: 110 / 240V AC
- Remote control
- Dimensions: 430mm x 320mm x H 130mm

## FRONT PANEL

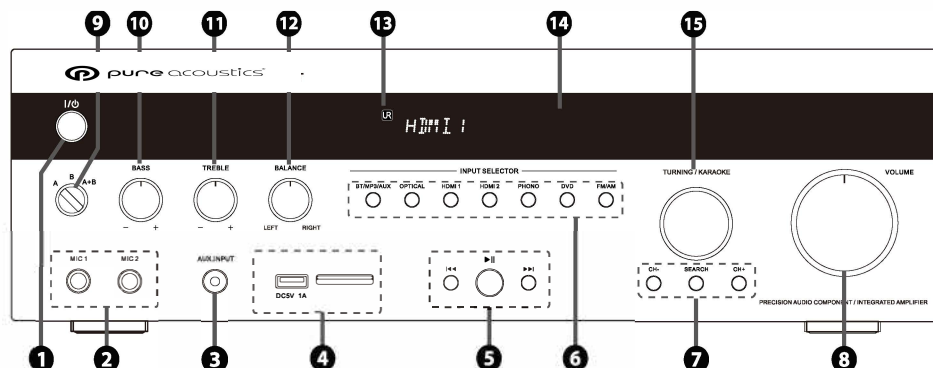

1. Power ON/OFF switch
2. Wired microphones input port
3. AUX Input
4. USB/MMC input port
5. USB/MMC/Wireless Music Stream mode: reverse, play/pause, forward
6. Input selector switch
7. CH-: Press to choose previous channel  
SEARCH: automatic search and save channels  
CH+: press to choose next channel
8. Volume adjustment
9. Speaker output A, B selector switch
10. Bass adjustment
11. Treble adjustment
12. Balance adjustment
13. Remote receive window
14. VFD display
15. Turn the knob forward or back to choose stations (e.g: 87.5, 87.6, 87.7...etc) , press to save stations

## REMOTE

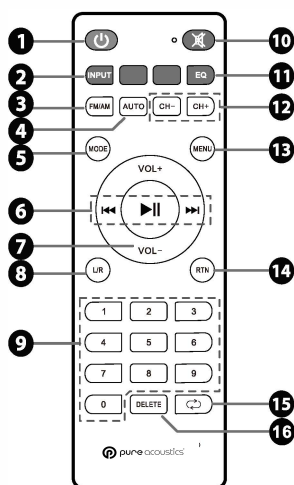

1. Power ON/OFF
2. Input selector
3. FM/AM selector
4. Automatically search for radio functions
5. Music, Movie, Wireless Music Stream, AV input... mode selector
6. Reverse, play/pause, forward
7. Volume adjustment
8. Channel conversion (movie mode)
9. Numeric straight selection key
10. Mute
11. Sound quality selection
12. Preset radio station selection
13. Menu function settings to enter
14. Exit the menu function
15. Single cycle and all cycle selection
16. Numeric error reset key

## REAR PANEL

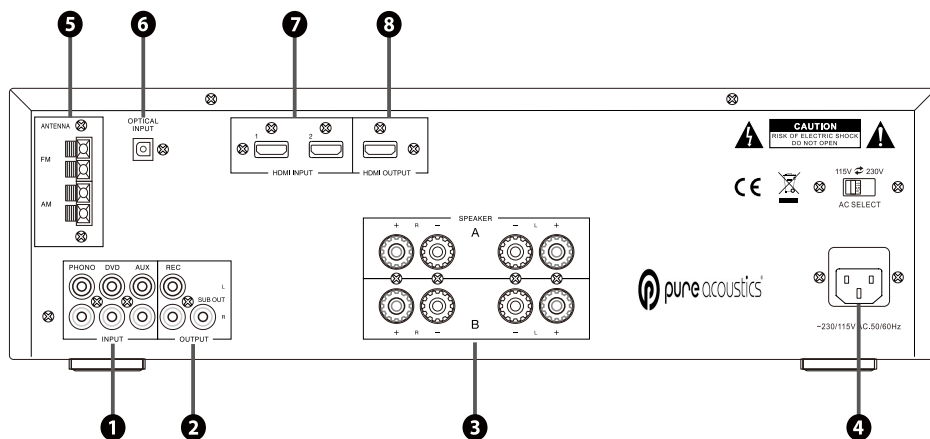

1. Stereo audio input
2. Audio output to active subwoofer and REC equipment
3. A/B group Speakers output
4. 240V AC input
5. FM/AM antenna
6. Optical audio signal input
7. HDMI blue-ray player input
8. HDMI audio/video output

## SETUP & OPERATION

### Getting start

Plug the AC power cord into your local AC convenience outlet. Be sure that the power source is within the voltage range indicated at the back of the product. The main power switch of the product should be at OFF position. Plug your external player/s into the AC outlet of the product. The total power consumption of the equipments connected to the AC outlet of the product must not exceed to the specification indicated.

### Audio input operation (Front panel)

Set the INPUT **6** selector switch to where your external audio or video player you want to operate is connected. Set the music volume **8** control to minimum (full counterclockwise). Switch on the power to both equipments. Operate the external player connected to the audio input of the product. Connect set of speakers to the speaker output of product. Adjust the music volume **8** control to the proper output level to avoid damage to the speakers and/or to the internal circuit of the product. Adjust the BASS **10** and TREBLE **11** controls according to your listening preferences. To enhance the highs and lows, balance **12** control will adjust the ratio of the left and right front speaker output level.

## USB / MMC Operation (Front panel)

Set the INPUT **6** selector knob switch to BT/MP3/AUX. Insert your USB/MMC flash memory to the USB/MMC port **4** of the product. It will automatically plays audio/video files stored in your flash memory. Front panel function button **5** for operate USB/MMC play function.

## Wireless Music Stream Operation (Front panel)

Set the INPUT **6** selector switch to BT/MP3/AUX. Press the button select BT mode (VFD screen will display). Enable the wireless music stream function of your external gadget and search the wireless music stream ID of the product (APA3500BT) then connect. Once connected, you can play audio files in your external gadget and listen the music to the hi-quality audio output of the product. You can use the audio playback control (▶▶, ▶, ◀◀) **5** of the product during wireless music stream operation depending on your gadget.

## FM /AM operation (Front panel)

Set the INPUT **6** selector switch to FM/AM. Press the FM/AM button select FM or AM, Turn the knob **15** forward or back to choose stations, press to save station. Press **7** automatic search and save channel, press CH- and CH+ to choose the channel you like.

## CONNECTIONS

### Wireless Music Stream Input

The Music Center features a wireless music stream input so you can connect your smartphone, tablet, or PC/Mac computer. Whenever your wireless music stream source allows for it, a wireless music stream aptX link will be established to give you high performance audio quality

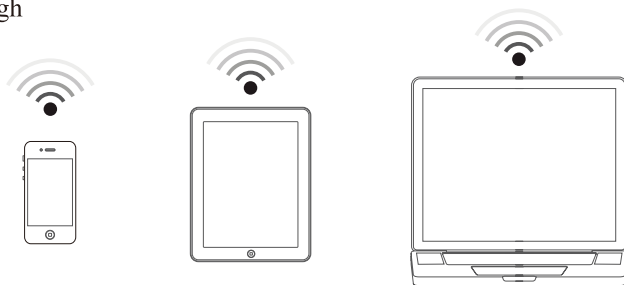
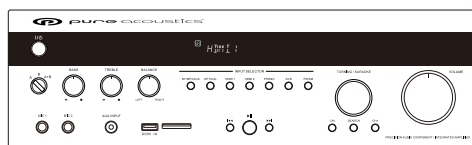



## Connecting Wireless Microphones

The wireless microphones can connect to the AUX input through connect cables (1/4 jack)

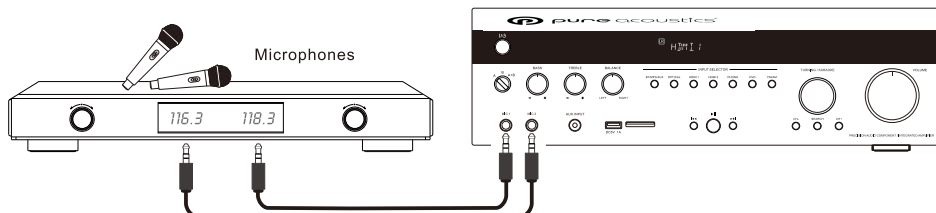

## USB / MMC and MP3

You can plug in a USB key / MMC card on the USB / MMC plug located on the side.

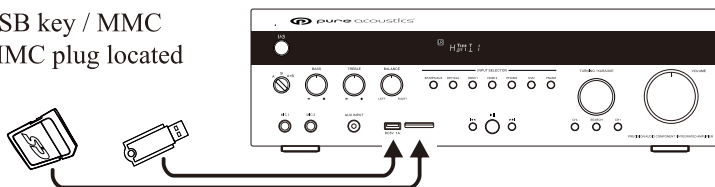

## MP3 Player Input

You can connect an I-POD / MP3 player or any other device equipped with headphones output by using the mini-jack cable

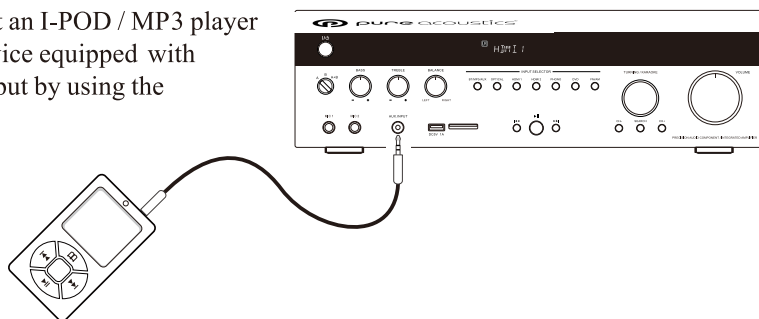

## Audio / Video input

You can link to devices equipped with RCA audio analog output

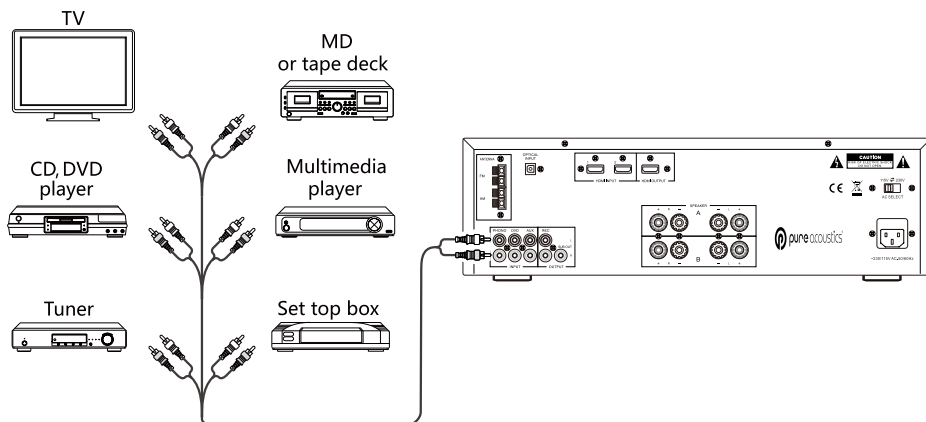

## Connecting Turntable

Connect the ground wire, but disconnect it if humming or other noise is generated

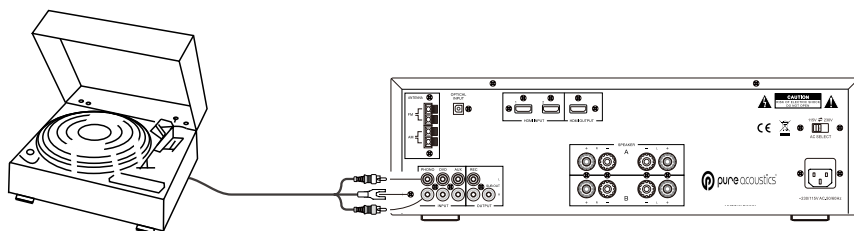

## Speakers Connection

When connecting your speakers, connect the left speaker to the L terminal block and the right speaker to the R terminal

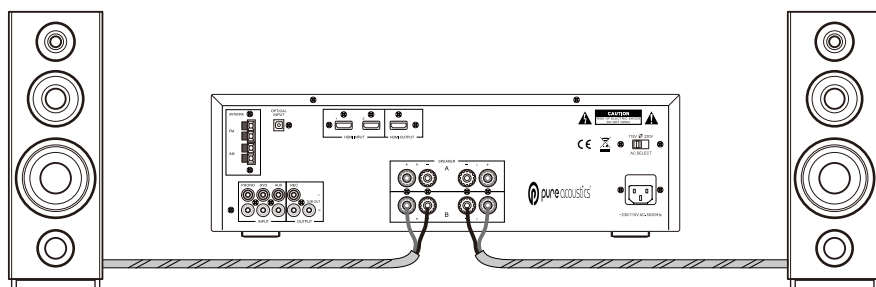

Match up the cable ends: the plus on the amplifier to the plus on the speaker, the minus on the amplifier to the minus of the speaker. You can connect your speakers in two different ways:

- Stripped cable: strip or twist 10 mm of cable before introducing it into the terminal

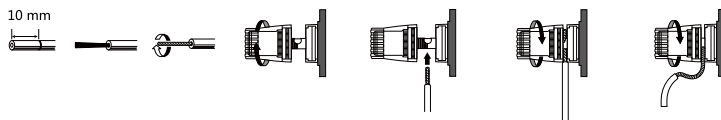

- Cable with banana plug: remove the protector located at the center of the terminal and insert the banana plug

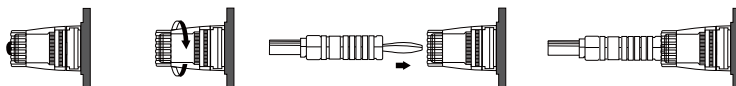

## FM / AM Tuner

To receive a radio signal, the antenna cable included should be attached to the << Radio Antenna >> plug

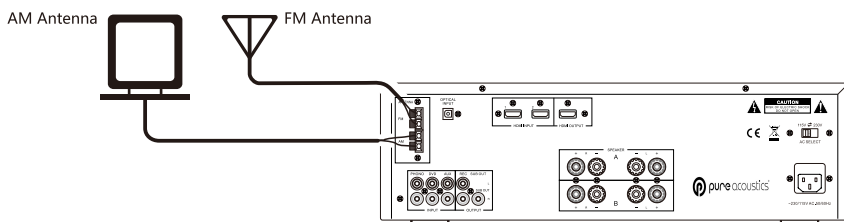

## Subwoofer

To connect a bass box

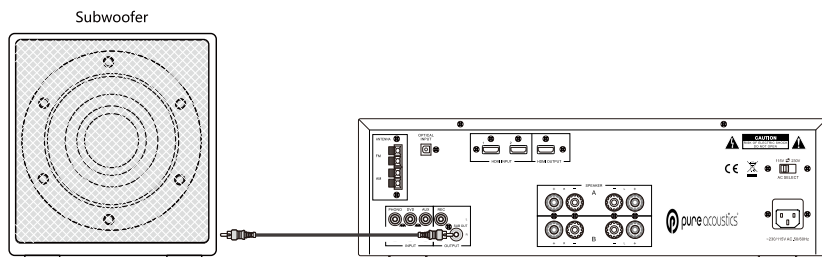

**WARRANTY INFORMATION****Disclaimer**

**Pure Acoustics** is not liable for any damage to speakers, amplifiers, or any other equipment that is caused by negligence or improper installation and/or use of the APA series amplifiers

**Product Warranty**

**Pure Acoustics** guarantees the APA series amplifiers to be free from defective material and/or workmanship for a period of one years from the date of sale, and will replace defective parts and repair malfunctioning products under this warranty when the defect occurs under normal installation and use provided the unit is returned to our factory via prepaid transportation with a copy of the proof of purchase. i.e., sales receipt. This warranty provides that examination of the returned product must indicate, in our judgment, a manufacturing defect. This warranty does not extend to any product which has been subjected to misuse, neglect, accident, improper installation, or where the date code has been removed or defaced.